

FEATURES

1. Semi-Open Impeller

- Adjustable wear plate increases wear life when pumpage contains heavy abrasive particles.
- 28% High Chrome 650+ Brinell hardness assures long life of impeller, wear plate and casing.

2. Slurry Mechanical Seal

- Dual seals of Silicon Carbide vs. Silicon Carbide running without the need for flush water.
- The motor is further protected by a labyrinth seal and upper lip seals.

3. Heavy-Duty Wash-Down Motor

- Inverter-duty TEFC, severe service, low voltage motor minimizes cost of operation.

4. No Packing or Shaft Sleeves

- Mechanical seal is self-contained, requiring no adjustments or flush water for lubrication.

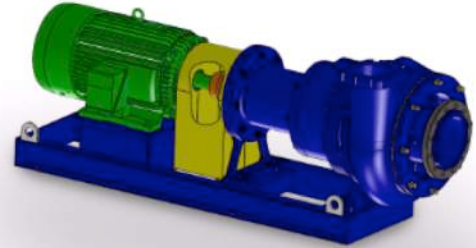

If you have problems with packing and sealing water, this pump will solve all your problems.

SPECIFICATIONS

STANDARD

Horsepower	15 – 200 HP
Discharge Size	3" – 8"
Performance Range	
Capacity	100 - 3400 US GPM
Head	10' – 140' TH
Solids Handling	1-3/8" to 2-1/2" Particle Size
Motor Nomenclature	
Type / Speed / HZ	TEFC Air-Filled / 1180 to 1780 RPM / 60 HZ
Voltage / Phase	230, 460, 575 V / 3 Phase
Service Factor	1.15
Insulation	Class F
Maximum Water Temperature	180° F
Operation Mode	Synchronous Speed or V.F.D.
Materials of Construction	
Casing	28% High Chrome 650+ Brinell Hardness
Impeller	28% High Chrome 650+ Brinell Hardness
Wear Plate	28% High Chrome 650+ Brinell Hardness
Shaft	416 Stainless Steel
Bearing Housing	Cast Iron
Fasteners	316 Stainless Steel

SPECIFICATIONS

STANDARD

Impeller Type	Semi-Open
Mechanical Seal	
Upper Seat	Silicon Carbide
Upper Rotator	Silicon Carbide
Lower Seat	Silicon Carbide
Lower Rotator	Silicon Carbide
Elastomers	Viton
Labyrinth Seal	Cast Steel
Lubrication	Mobil / Synturion 6
Bearings	
Thrust	Double Angular Contact
Radial	Deep Groove Ball Bearing
Lubrication	Permanently Lubricated with Mobil SHC Polyrex 222
Accessories	Agitators / Discharge Hose / Variable Speed / Urethane Coating / Elbows in Steel or High Chrome / Control Panels / Moisture and Thermal Protection / Rafts