

## FEATURES

- Heavy duty semi-open impeller for pumping abrasive solids.
- 28% High Chrome 650+ Brinell hardness assures long life of impeller, wear plate and casing.
- Dual seals of Silicon Carbide vs. Silicon Carbide seals run in bath of barrier fluid which removes the need for flush water.
- Inverter-duty, air-filled, copper-wound motor (TENV) for use on VFD's.
- Class H insulation.
- Extended run dry capabilities when sized appropriately for the application.
- Inverter-duty, air-filled, copper-wound motor.
- Class H insulation.
- Large Diameter shafts to increase seal and bearing life with minimal deflection.
- Maximum material thickness of liquid end parts to maximize service life.

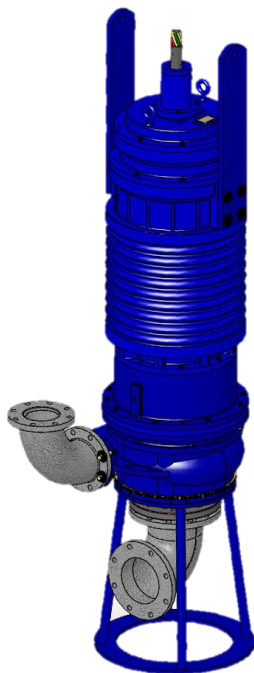

## SPECIFICATIONS

**Horsepower**  
**Discharge Size**  
**Performance Range**  
Capacity  
Head  
**Max Particle Size**  
**Motor Nomenclature**  
Type / Speed / HZ  
  
Voltage / Phase  
Service Factor  
Insulation  
Cable Length  
**Maximum Water Temperature**  
**Operation Mode**  
**Materials of Construction**  
Casing  
  
Impeller  
  
Wear Plate  
  
Shaft  
Bearing Housing  
  
Fasteners  
**Impeller Type**  
**Mechanical Seal**  
Seal Faces  
Elastomers  
Labyrinth Seal  
Lubrication  
**Bearings**  
Thrust  
Radial  
**Lubrication**  
  
**Accessories**

## STANDARD

15 - 500 HP  
3" – 8"  
  
100 - 6250 US GPM  
10' – 140' TH  
4-1/2"  
  
TENV Air-Filled / 900 to 1800 RPM / 60 HZ  
460, 575 V / 3 Phase  
1.5  
Class H  
33' (Length option available)  
180° F+  
Synchronous Speed or V.F.D.  
  
28% High Chrome 650+ Brinell Hardness  
28% High Chrome 650+ Brinell Hardness  
28% High Chrome 650+ Brinell Hardness  
416 Stainless Steel  
Cast Iron 3/8" Minimum Thickness  
18-8 Stainless Steel  
Semi-Open  
  
Silicon Carbide  
Viton  
Stainless Steel/Cast Steel  
Mobil / Synturion 6  
  
Double Angular Contact  
Deep Groove Ball Bearing  
Permanently Lubricated with Mobil SHC Polyrex 222  
Agitators / Discharge Hose / Variable Speed / Urethane Coating / Elbows in Steel or High Chrome / Control Panels / Moisture and Thermal Protection / Rafts

**Mount vertically outside the tank where there is a possibility of flooding. Save floor space by 50%.**